

BASO 1.5 WALL WASH



Catalog Number Example

BASO 1.5-RTL-WH-WW-30K-C80-UNV-010V-SEN-0400LF-NLC-ST-24IN-CCEA

PERFORMANCE

- Up to 103lm/W efficiency
- 400 / 600 / 800lm/ft
- CRI > 80 & CRI > 90
- IC & Damp rated

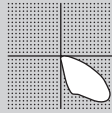

MOUNTING

Recessed



PATTERNS



Rectangles



Angles

For customization, please contact customer service

BEAM DISTRIBUTION



Wall to ceiling ratio	
Room height	H = 9 ft
Distance to wall	A = 3 ft
Reflection factor	0.7 0.5 0.2
Maintenance factor	0.8
Eye level	4 - 5 ft

[link to page](#)

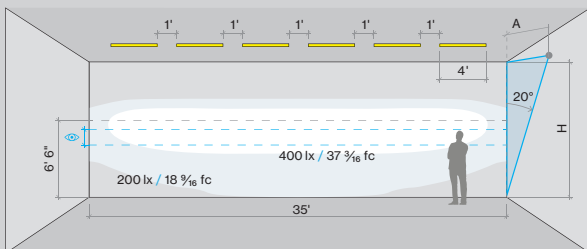

A RANGE

BASO 1.5 BASO 1.5

B MOUNTING

Recessed trimless	RTL
Recessed with trim	RTL
Armstrong Suprafine 9/16" G	A 9 G
Armstrong Interlude 9/16" SG	A 9 S
Armstrong Silhouette 9/16" BSG	A 9 S
Armstrong Prelude 15/16" G	A 1 5
9/16" Grid (any brand)	9 GR
9/16" Slot Grid (any brand)	9 SG
15/16" Grid (any brand)	1 5 G
Custom	X X X

C COLOR

White	WH
Black	BL
Gray	GR
Custom color RAL	X X

trimless version available in white only

D LENS

Asymmetric wall washer WW

E CCT

2700K	2 7 K
3000K	3 0 K
3500K	3 5 K
4000K	4 0 K

F CRI

CRI > 80	C 8 0
CRI > 90	C 9 0

G VOLTAGE

120V / 277V UNV

H DIMMING

0-10V 1%	0 1 0 V
Lutron EcoSystem	L E S 1
Quantum, Vive, GRAFIK Eye, HomeWorks	
Power over ethernet	P O E C
consult customer service for compatibility	
Custom dimming	X X X X
consult customer service for compatibility	

I SENSOR (optional)

Integrated Sensor SEN
consult customer service for sensor request

J OUTPUT LM/FT

400lm/ft 100% \pm	0 4 0 0 L F
600lm/ft 100% \pm	0 6 0 0 L F
800lm/ft 100% \pm	0 8 0 0 L F
Custom lm/ft	X X X X L F

custom lumen up to 800 lm/ft

K CIRCUIT / EM

Single circuit	*
EMC night light circuit	N L C
EMB available in 4ft and 8ft	E M #

* leave blank

L SHAPE / PATTERN

Linear / straight	S T
L-shape inner	L I
L-shape outer	L O
□-shape inner	R I
□-shape outer	R O
U-shape inner	U I
U-shape outer	U O
custom shape	X X

please contact customer service for availability

M DIMENSIONS IN INCH

Linear 2'	2 4 I N
Linear 4'	4 8 I N
Linear 6'	7 2 I N
Linear 8'	9 6 I N
Linear custom	### I N
L-Shape	### X ### I N
U-Shape	### X ### X ### I N
□-Shape	### X ### I N

N CERTIFICATION (optional)

Chicago Plenum	C C E A
Red List Approved	R L A

BASO
basolighting.com
xalusa.com

Technical data

	SIZE TYPE	LED COLOR TEMPERATURE	INPUT WATTS	DELIVERED LM TOTAL	LIGHT DISTRIBUTION	DELIVERED LM DIRECT	OPTICAL EFFICIENCY	LUMINAIRE EFFICACY
BASO DIRECT								
e LED	4' linear	30K, 35K, 40K	16W	1600lm	100% down	400lm/ft	67%	103lm/W
	8' linear		32W	3200lm				
e ² LED	4' linear	30K, 35K, 40K	24W	2400lm	100% down	600lm/ft	67%	99lm/W
	8' linear		48W	4800lm				
e ²⁺ LED	4' linear	30K, 35K, 40K	36W	3200lm	100% down	800lm/ft	67%	93lm/W
	8' linear		72W	6400lm				

Patterns top view

LINEAR



A	FIXTURES	CODE
48"	1 × 4' linear	0 4 F T
96"	1 × 8' linear	0 8 F T
144"	3 × 4' linear	1 2 F T

L-SHAPE OUTER

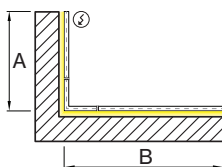

A / B	FIXTURES	CODE
48" / 48"	2 × 2' linear + 1 × 2' × 2' corner	0 4 X 0 4 F T
48" / 96"	1 × 2' linear + 1 × 6' linear + 1 × 2' × 2' corner	0 4 X 0 8 F T
96" / 96"	2 × 6' linear + 1 × 2' × 2' corner	0 8 X 0 8 F T

L-SHAPE INNER

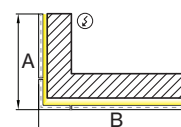

A / B	FIXTURES	CODE
48" / 48"	2 × 2' linear + 1 × 2' × 2' corner	0 4 X 0 4 F T
48" / 96"	1 × 2' linear + 1 × 6' linear + 1 × 2' × 2' corner	0 4 X 0 8 F T
96" / 96"	2 × 6' linear + 1 × 2' × 2' corner	0 8 X 0 8 F T

LIGHT DIRECTION DIAGRAM



DIMENSIONS

BASO 1.5 WALL WASHER

RECESSED trimless

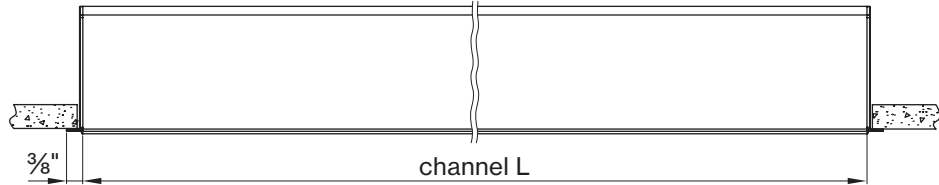
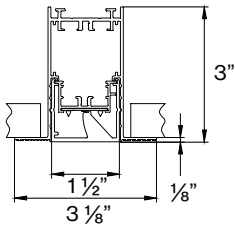

RECESSED with trim

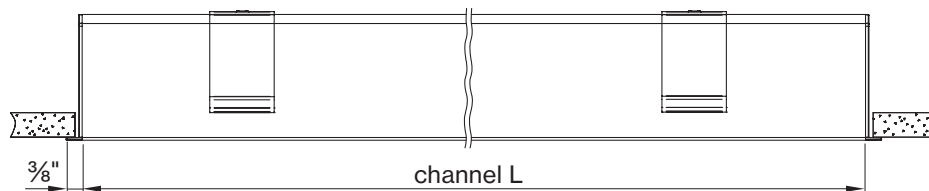
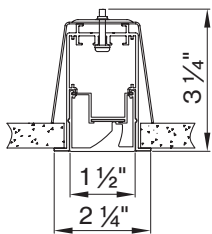

9/16" Grid (any brand)

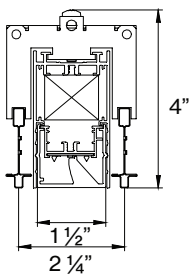

9/16" Grid (any brand) 4ft

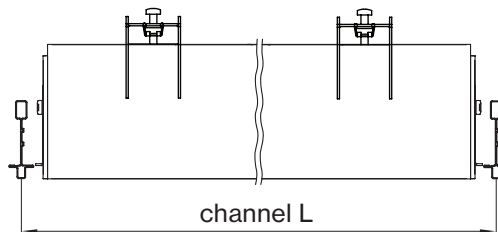

1 5/16" Grid (any brand)

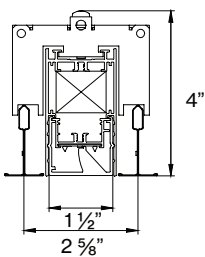

1 5/16" Grid (any brand) 4ft

Declare.

BASO 1.5 2.5 4.0
XAL USA Incorporated
 Final Assembly: Collins, Connecticut, USA
 LBC (Declare's brand)
 End of Life Options: Recyclable (70%), Landfill (30%)

Ingredients
 Aluminum, 2-Phenolacetic acid, 2-methyl-, methyl ester, polymer with ethyl 2-cyanobenzoyl, steel, manufacture, chemical, Copper chloride (CuCl₂), Polyvinyl Chloride (Unrestrained Substrate), Polypropylene (about 100%), Acrylic (about 100%),
 Copper, Ink, Ink, Organic Solvent, Zinc

1. LBC Temp Exception RE_C003 - Small Electrical Components

Living Building Challenge Criteria:

H3 Red List:
 LBC Red List Free: Discarded 100% at 100ppm
 LBC Red List Approved: VOC Content: Not Applicable
 Recycled:

H3 Interior Performance: Not Applicable
H4 Responsible Sourcing: Not Applicable

XAL-0002
 03/10/2024
 Original Issue Date: 2023
 INTERNATIONAL LEARNING FORUM ASSOCIATION - LEARNING FORUM

BASO mounting instructions

Get access to the BASO 1.5 WW mounting instructions faster by scanning the QR code.

www.xalusa.com/resources/mounting-instructions/baso

